

Thomas Steward formerly

John Reed

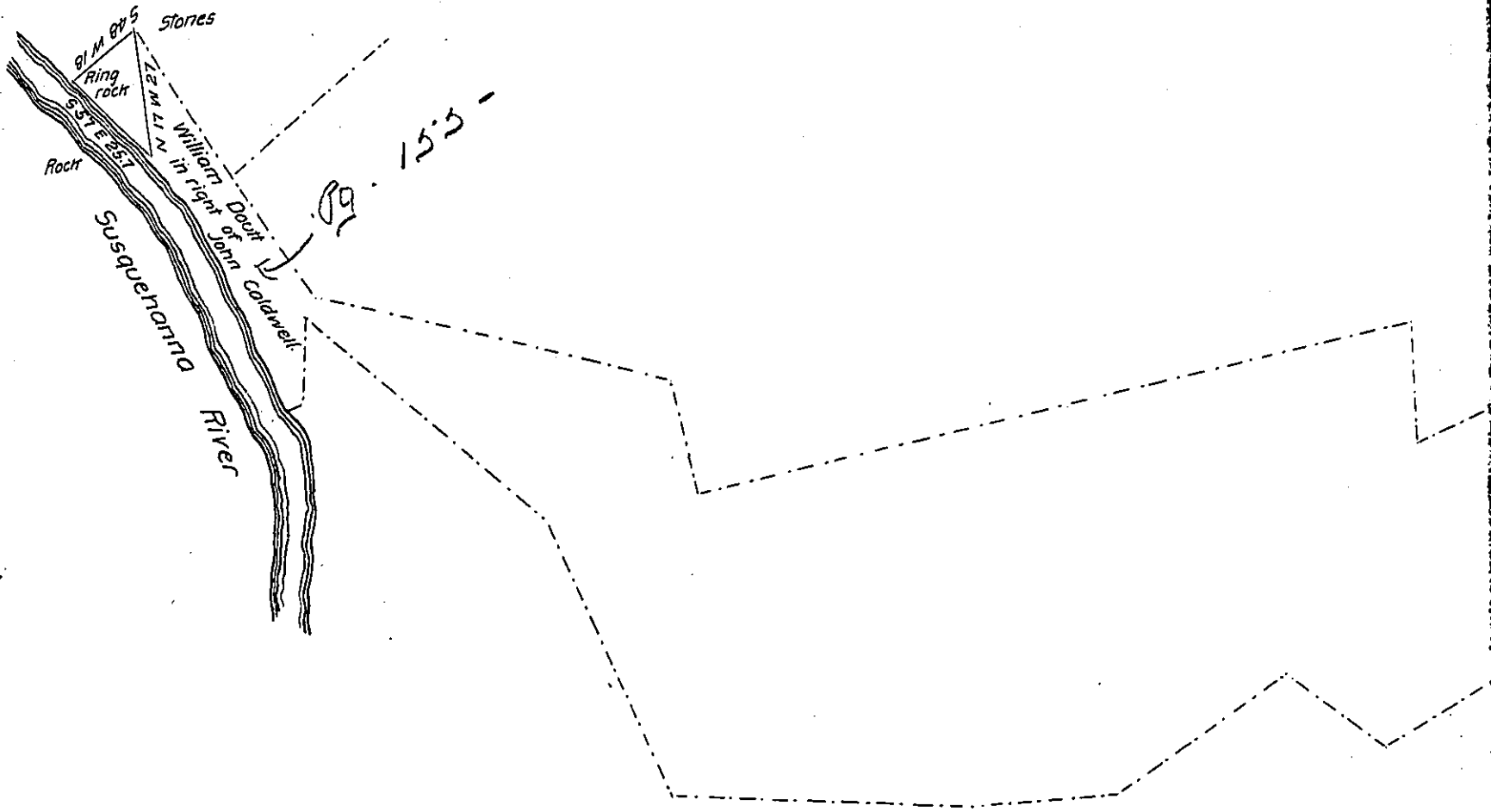

The above draught represents a lot or piece of land in Martic township Lancaster County Containing 1 acre & 49 perches and the usual allowance of Six per cent for roads &c. being part of 87 acres & 144 ps. and allowance which was surveyed to George Sides and Peter Young August 31st 1819 in pursuance of a warrant dated the 3rd day of April A. D. 1786 granted to John Caldwell.

Surveyed the above part for Henry Galen February 23rd 1859.

To John Rowe Esqr.

John C. Lewis

Surveyor General.

Surveyor for Lancaster County.

IN TESTIMONY that the above is a copy of the original remaining on file in the Department of Internal Affairs of Pennsylvania, made conformably to an Act of Assembly approved the 16th day of February, 1833, I have hereunto set my Hand and caused the Seal of said Department to be affixed at Harrisburg, this twenty-eighth day of September 1904

Loac R. Brown
 Secretary of Internal Affairs.